

③ 增加束線帶

NOTE:

1. ALL THE LENGTH OF OUTPUT WIRES EXCLUDE HOUSING.
2. 所有膠殼均需使用黑色膠殼(CON3及其對應8Pin膠殼除外).
3. 公差: .XX=±0.5 [0.02]、.XXX=±0.25 [0.01]

UNIT:mm [inch]

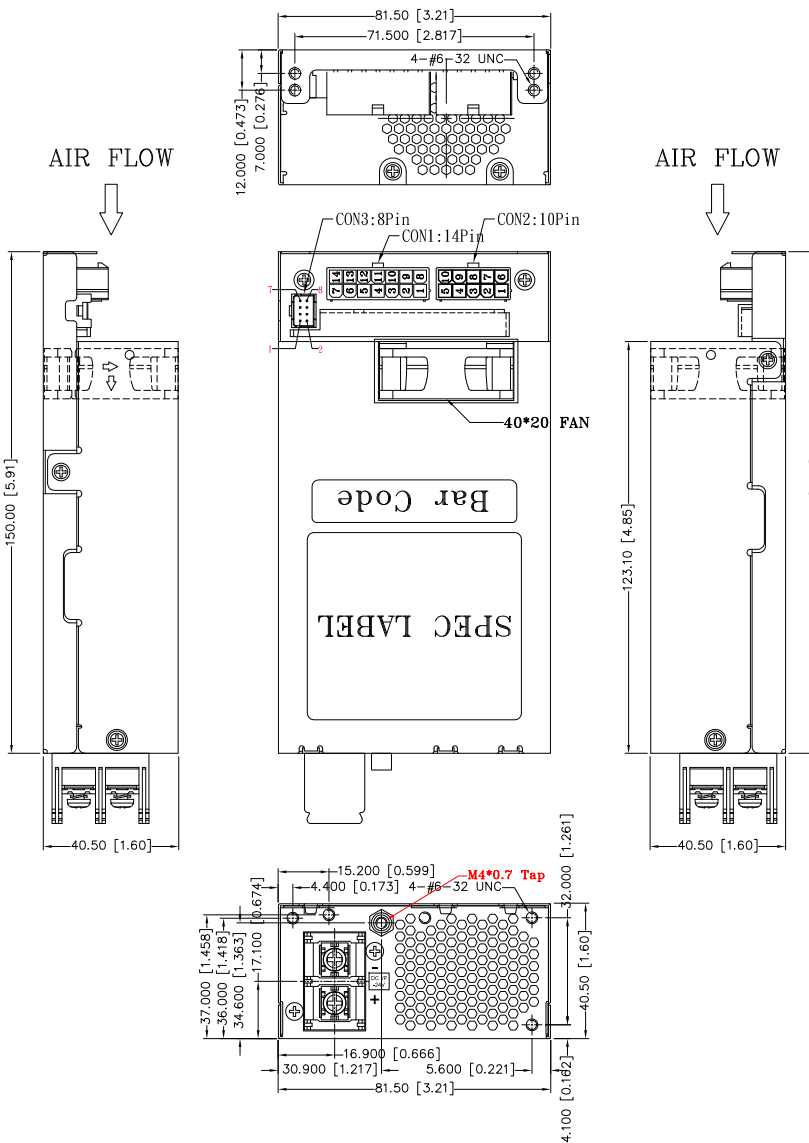

REF. ID.	PIN NO.	SIGNAL	WIRE COLOR	GAUGE	CONNECTOR TYPE	CABLE LENGTH
P1	1	+3.3V	ORANGE	18	WST	200±15mm
	2	+3.3V	ORANGE	18	P20-142002Z-B or EQUIV.	
	3	COM	BLACK	18		
	4	+5V	RED	18		
	5	COM	BLACK	18		
	6	+5V	RED	18		
	7	COM	BLACK	18		
	8	PW-OK	GRAY	24		
		PW-OK	GRAY	24		
	9	+5Vsb	PURPLE	24		
		+5Vsb	PURPLE	24		
	10	+12V	YELLOW	18		
	11	+3.3V	ORANGE	18		
		+3.3Vsense	BROWN	24		
	12	-12V	BLUE	24		
	13	COM	BLACK	18		
	14	PS-ON	GREEN	24		
		PS-ON	GREEN	24		
	15	COM	BLACK	18		
	16	COM	BLACK	18		
17	COM	BLACK	18			
18						
19	+5V	RED	18			
20	+5V	RED	18			
P2	1	COM	BLACK	18	WST	310±15mm
	2	COM	BLACK	18	P4-142002Z-B or EQUIV.	
	3	+12V	YELLOW	18		
	4	+12V	YELLOW	18		
PA	1	+12V	YELLOW	18	WST	250±15mm
	2	COM	BLACK	18	P4-A10202Z-B or EQUIV.	
	3	COM	BLACK	18		
	4	+5V	RED	18		
PB	1	+5V	RED	20	AMP	155±10mm
	2	COM	BLACK	20	2-171822-4 or EQUIV.	
	3	COM	BLACK	20		
	4	+12V	YELLOW	20		
PC	1	+3.3V	ORANGE	18	WST	310±15mm
	2	COM	BLACK	18	P5-112718-B or EQUIV.	
	3	+5V	RED	18		
	4	COM	BLACK	18		
	5	+12V	YELLOW	18		
PD	1	+3.3V	ORANGE	18	WST	155±10mm
	2	COM	BLACK	18	P5-112718-B or EQUIV.	
	3	+5V	RED	18		
	4	COM	BLACK	18		
	5	+12V	YELLOW	18		

P/N.:9PD2500200

MODEL NO. : FSP250-52FGB(STD0001)		TITLE: ASSY	SHEET: 1 OF 1 REV:03
R&D(2)	PE	DRAWN	DATE
			NOV.02.2018
INTERIOR COUNTERSIGN:			